

20V^{MAX} POWER SHARE™

SAFETY AND OPERATING MANUAL

ORIGINAL INSTRUCTIONS

Cordless shrub shear / grass shear
WG801E WG801E.1 WG801E.9

GENERAL POWER TOOL SAFETY WARNINGS



WARNING: Read all safety warnings and all instructions. Failure to follow the warnings and instructions may result in electric shock, fire and/or serious injury.

Save all warnings and instructions for future reference.

The term "power tool" in the warnings refers to your mains-operated (corded) power tool or battery-operated (cordless) power tool.

1. WORK AREA SAFETY

- a) **Keep work area clean and well lit.** Cluttered or dark areas invite accidents.
- b) **Do not operate power tools in explosive atmospheres, such as in the presence of flammable liquids, gases or dust.** Power tools create sparks which may ignite the dust or fumes.
- c) **Keep children and bystanders away while operating a power tool.** Distractions can cause you to lose control.

2. ELECTRICAL SAFETY

- a) **Power tool plugs must match the outlet. Never modify the plug in any way. Do not use any adapter plugs with earthed (grounded) power tools.** Unmodified plugs and matching outlets will reduce risk of electric shock.
- b) **Avoid body contact with earthed or grounded surfaces, such as pipes, radiators, ranges and refrigerators.** There is an increased risk of electric shock if your body is earthed or grounded.
- c) **Do not expose power tools to rain or wet conditions.** Water entering a power tool will increase the risk of electric shock.
- d) **Do not abuse the cord. Never use the cord for carrying, pulling or unplugging the power tool. Keep cord away from heat, oil, sharp edges or moving parts.** Damaged or entangled cords increase the risk of electric shock.
- e) **When operating a power tool outdoors, use an extension cord suitable for outdoor use.** Use of a cord suitable for outdoor use reduces the risk of electric shock.
- f) **If operating a power tool in a damp location is unavoidable, use a residual current device (RCD) protected supply.** Use of an RCD reduces the risk of electric shock.

3. PERSONAL SAFETY

- a) **Stay alert, watch what you are doing and use common sense when operating a power tool. Do not use a power tool while you are tired or under the influence of drugs, alcohol or medication.** A moment of inattention while operating power tools may result in serious personal injury.
- b) **Use personal protective equipment. Always wear eye protection.** Protective equipment

such as dust mask, non-skid safety shoes, hard hat, or hearing protection used for appropriate conditions will reduce personal injuries.

- c) **Prevent unintentional starting. Ensure the switch is in the off-position before connecting to power source and/or battery pack, picking up or carrying the tool.** Carrying power tools with your finger on the switch or energising power tools that have the switch on invites accidents.
- d) **Remove any adjusting key or wrench before turning the power tool on.** A wrench or a key left attached to a rotating part of the power tool may result in personal injury.
- e) **Do not overreach. Keep proper footing and balance at all times.** This enables better control of the power tool in unexpected situations.
- f) **Dress properly. Do not wear loose clothing or jewellery. Keep your hair, clothing and gloves away from moving parts.** Loose clothes, jewellery or long hair can be caught in moving parts.
- g) **If devices are provided for the connection of dust extraction and collection facilities, ensure these are connected and properly used.** Use of dust collection can reduce dust-related hazards.

4. POWER TOOL USE AND CARE

- a) **Do not force the power tool. Use the correct power tool for your application.** The correct power tool will do the job better and safer at the rate for which it was designed.
- b) **Do not use the power tool if the switch does not turn it on and off.** Any power tool that cannot be controlled with the switch is dangerous and must be repaired.
- c) **Disconnect the plug from the power source and/or the battery pack from the power tool before making any adjustments, changing accessories, or storing power tools.** Such preventive safety measures reduce the risk of starting the power tool accidentally.
- d) **Store idle power tools out of the reach of children and do not allow persons unfamiliar with the power tool or these instructions to operate the power tool.** Power tools are dangerous in the hands of untrained users.
- e) **Maintain power tools. Check for misalignment or binding of moving parts, breakage of parts and any other condition that may affect the power tool's operation. If damaged, have the power tool repaired before use.** Many accidents are caused by poorly maintained power tools.
- f) **Keep cutting tools sharp and clean.** Properly maintained cutting tools with sharp cutting edges are less likely to bind and are easier to control.
- g) **Use the power tool, accessories and tool bits etc. in accordance with these instructions, taking into account the working conditions and the work to be performed.** Use of the power tool for operations

different from those intended could result in a hazardous situation.

5. BATTERY TOOL USE AND CARE

- a) **Recharge only with the charger specified by the manufacturer.** A charger that is suitable for one type of battery pack may create a risk of fire when used with another battery pack.
- b) **Use power tools only with specifically designated battery packs.** Use of any other battery packs may create a risk of injury and fire.
- c) **When battery pack is not in use, keep it away from other metal objects, like paper clips, coins, keys, nails, screws or other small metal objects, that can make a connection from one terminal to another.** Shorting the battery terminals together may cause burns or a fire.
- d) **Under abusive conditions, liquid may be ejected from the battery; avoid contact. If contact accidentally occurs, flush with water. If liquid contacts eyes, additionally seek medical help.** Liquid ejected from the battery may cause irritation or burns.

6. SERVICE

- a) **Have your power tool serviced by a qualified repair person using only identical replacement parts.** This will ensure that the safety of the power tool is maintained.

GENERAL SAFETY WARNINGS



WARNING: Read all safety warnings and all instructions. Failure to follow the warnings and instructions may result in electric shock, fire and/or serious injury.

Save all warnings and instructions for future reference.

The appliance is only to be used with the power supply unit provided with the appliance

IMPORTANT READ CAREFULLY BEFORE USE KEEP FOR FUTURE REFERENCE

SAFE OPERATION PRACTICES TRAINING

- a) Read the instructions carefully. Be familiar with the controls and the proper use of the machine.
- b) Never allow children, persons with reduced physical, sensory or mental capabilities or lack of experience and knowledge or people unfamiliar with these instructions to use the machine. Local regulations can restrict the age of the operator.
- c) Keep in mind that the operator or user is responsible for accidents or hazards occurring to other people or their property.

PREPARATION

- a) Never operate the machine while people, especially children, or pets are nearby.
- b) Before use, always visually inspect the machine for damaged, missing or misplaced guards or shields.

OPERATION

- a) Wear eye protection, long trousers and stout shoes at all times while operating the machine.
- b) Avoid using the machine in bad weather conditions especially when there is a risk of lightning.
- c) Use the machine only in daylight or good artificial light.
- d) Never operate the machine with damaged guards or shields or without guards or shields in place.
- e) Switch on the motor only when the hands and feet are away from the cutting means.
- f) Always disconnect the machine from the power supply (e.g. remove the battery pack)
 - whenever leaving the machine unattended;
 - before clearing a blockage;
 - before checking, cleaning or working on the machine;
 - after striking a foreign object;
 - whenever the machine starts vibrating abnormally.
- g) Take care against injury to feet and hands from the cutting means.
- h) Always ensure that the ventilation openings are kept clear of debris.

HEDGE TRIMMER SAFETY WARNINGS

1. **Keep all parts of the body away from the cutter blade. Do not remove cut material or hold material to be cut when blades are moving. Make sure the switch is off when clearing jammed material.** A moment of inattention while operating the hedge trimmer may result in serious personal injury.
2. **Carry the hedge trimmer by the handle with the cutter blade stopped. When transporting or storing the hedge trimmer always fit the cutting device cover.** Proper handling of the hedge trimmer will reduce possible personal injury from the cutter blades.
3. **Hold the power tool by insulated gripping surfaces only, because the cutter blade may contact hidden wiring.** Cutter blades contacting a "live" wire may make exposed metal parts of the power tool "live" and could give the operator an electric shock.
4. Check the hedge for foreign objects, e.g. wire fences.
5. Use both hands when operating the hedge trimmer. Using one hand could cause loss of control and result in serious personal injury.

Cordless shrub shear / grass shear WG801E WG801E.1 WG801E.9

- i) Always be sure of your footing on slopes.
- j) Walk, never run.
- k) Not overreach and keep the balance at all times.
- l) Not to touch moving hazardous parts before the machine is disconnected and the moving hazardous parts have come to a complete stop.

MAINTENANCE AND STORAGE

- a) Disconnect the machine from the power supply (e.g. remove the battery pack) before carrying out maintenance or cleaning work.
- b) Use only the manufacturer's recommended replacement parts and accessories.
- c) Inspect and maintain the machine regularly. Have the machine repaired only by an authorized repairer.
- d) When not in use, store the machine out of the reach of children.

SAFETY WARNINGS FOR BATTERY PACK









- a) **Do not dismantle, open or shred cells or battery pack.**
- b) **Do not short-circuit a battery pack. Do not store battery packs haphazardly in a box or drawer where they may short-circuit each other or be short-circuited by conductive materials.** When battery pack is not in use, keep it away from other metal objects, like paper clips, coins, keys, nails, screws or other small metal objects, that can make a connection from one terminal to another. Shorting the battery terminals together may cause burns or a fire.
- c) **Do not expose battery pack to heat or fire. Avoid storage in direct sunlight.**
- d) **Do not subject battery pack to mechanical shock.**
- e) **In the event of battery leaking, do not allow the liquid to come into contact with the skin or eyes. If contact has been made, wash the affected area with copious amounts of water and seek medical advice.**
- f) **Seek medical advice immediately if a cell or battery pack has been swallowed.**
- g) **Keep battery pack clean and dry.**
- h) **Wipe the battery pack terminals with a clean dry cloth if they become dirty.**
- i) **Battery pack needs to be charged before use. Always refer to this instruction and use the correct charging procedure.**
- j) **Do not maintain battery pack on charge when not in use.**
- k) **After extended periods of storage, it may be necessary to charge and discharge the battery pack several times to obtain maximum performance.**
- l) **Battery pack gives its best performance when it is operated at normal room temperature (20°C ± 5°C).**
- m) **When disposing of battery packs, keep**

battery packs of different electrochemical systems separate from each other.

- n) **Recharge only with the charger specified by WORX.** Do not use any charger other than that specifically provided for use with the equipment. A charger that is suitable for one type of battery pack may create a risk of fire when used with another battery pack.
- o) **Do not use any battery pack which is not designed for use with the equipment.**
- p) **Keep battery pack out of the reach of children.**
- q) **Retain the original product literature for future reference.**
- r) **Remove the battery from the equipment when not in use.**
- s) **Dispose of properly.**

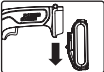
SYMBOLS

	To reduce the risk of injury, user must read instruction manual
	Wear ear protection
	Wear eye protection
	Wear dust mask
	Do not expose to rain
	WARNING: cutting means continues to run after the motor is switched off
	Keep bystanders away

	Class III appliance
	Waste electrical products must not be disposed of with household waste. Please recycle where facilities exist. Check with your local authorities or retailer for recycling advice.
 Li-Ion	Do not dispose of batteries, Return exhausted batteries to your local collection or recycling point.
	Do not expose to rain or water
	Do not burn
	Make sure the battery is removed prior to changing accessories.
	Wear protective gloves.
	Lock
	Unlock

Cordless shrub shear / grass shear
WG801E WG801E.1 WG801E.9

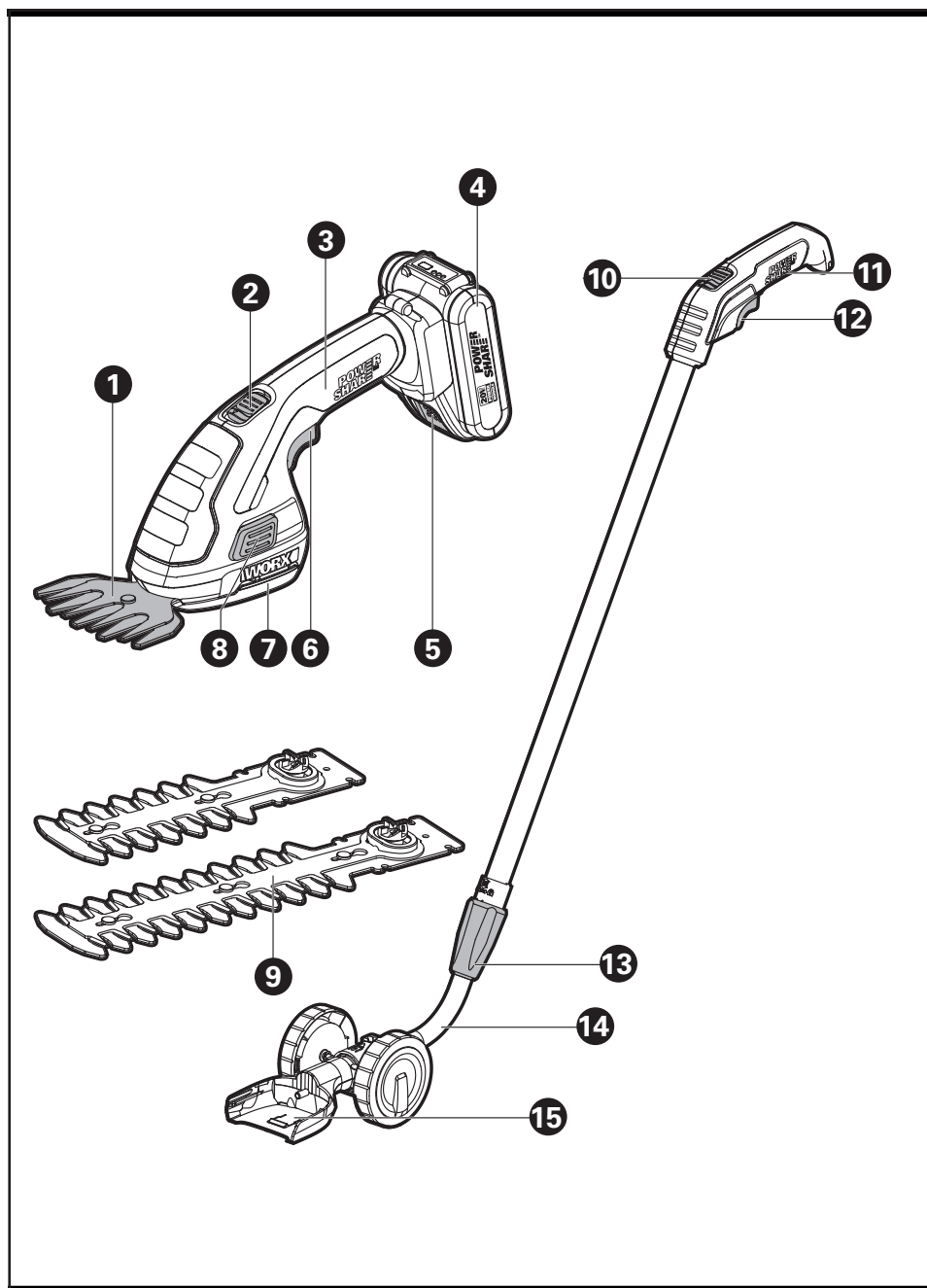

Cordless shrub shear / grass shear
WG801E WG801E.1 WG801E.9

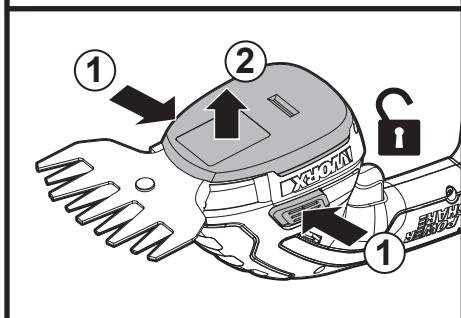
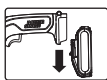
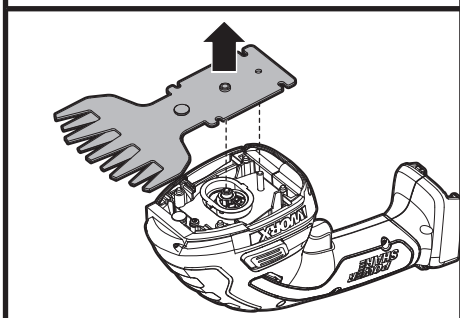
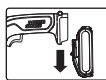
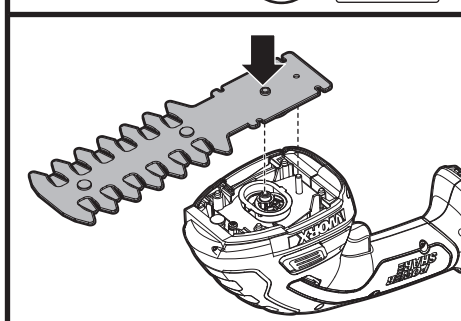
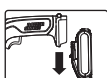
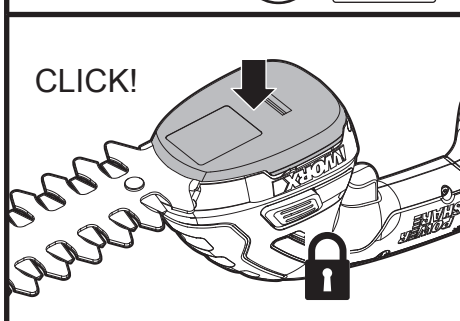
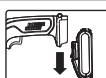
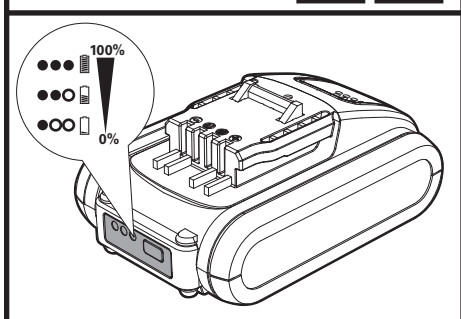
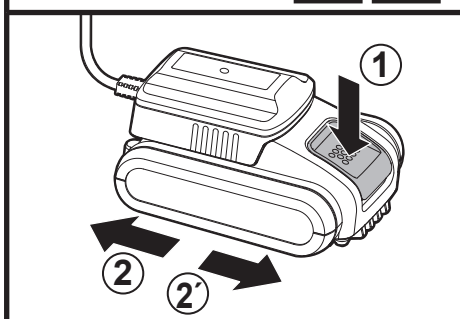
A1**A2****B1****B2****C1****C2**

**Cordless shrub shear / grass shear
WG801E WG801E.1 WG801E.9**

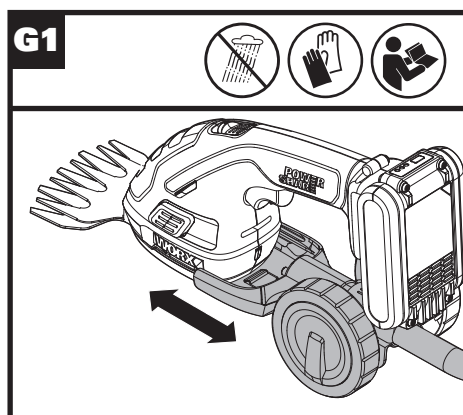
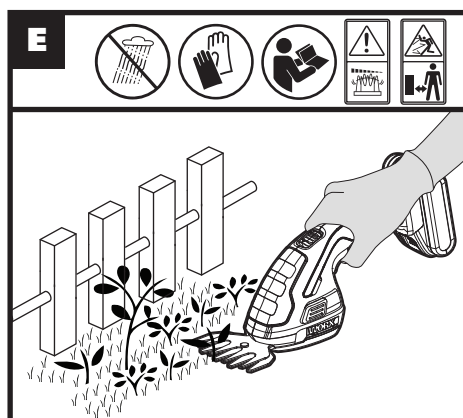
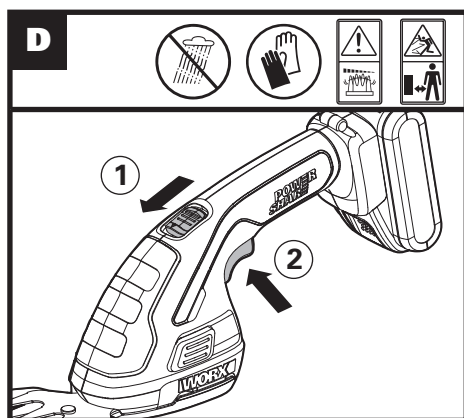
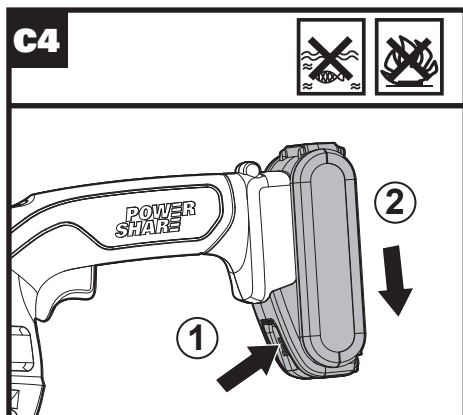
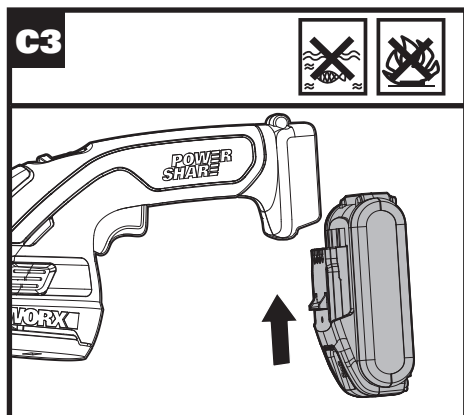

**Cordless shrub shear / grass shear
WG801E WG801E.1 WG801E.9**

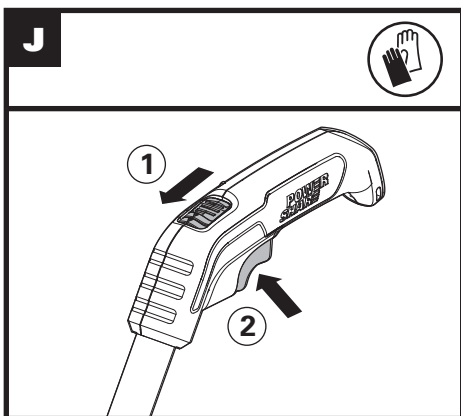
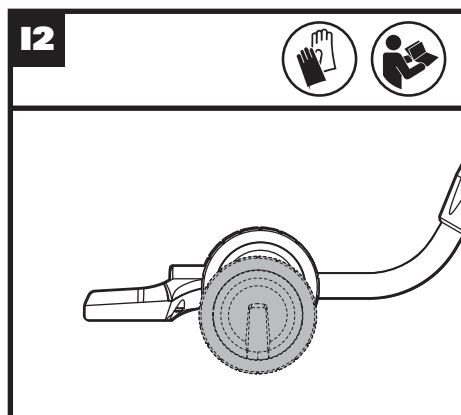
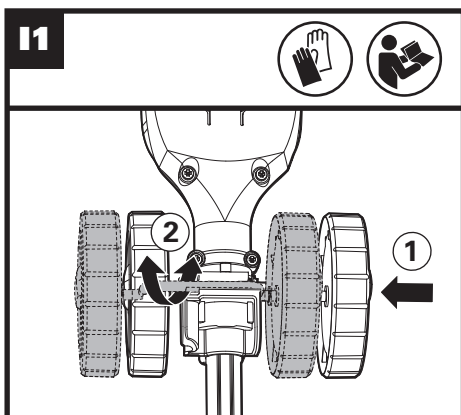
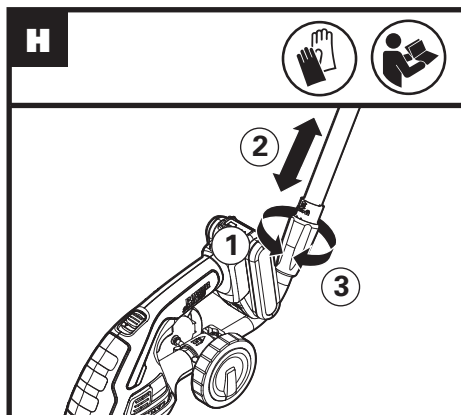
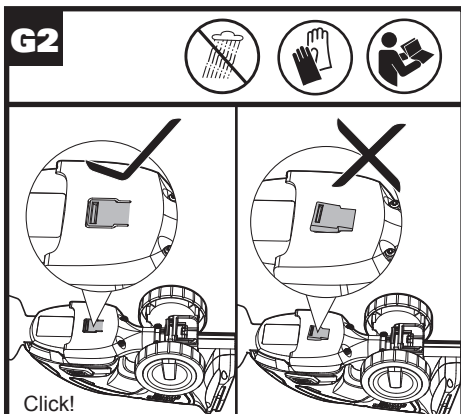

**Cordless shrub shear / grass shear
WG801E WG801E.1 WG801E.9**

COMPONENT LIST

1.	GRASS SHEAR BLADE
2.	LOCK-OFF BUTTON
3.	HANDLE
4.	BATTERY PACK *
5.	BATTERY PACK RELEASE BUTTON *
6.	ON/OFF SWITCH
7.	TOOL-FREE DRIVE COVER
8.	TOOL-FREE DRIVE COVER RELEASE BUTTON
9.	SHRUB SHEAR BLADES (2 PCS) *
10.	LOCK-OFF BUTTON ON TELESCOPIC HANDLE (ONLY FOR WG801E.1)
11.	TELESCOPIC POLE HANDLE (ONLY FOR WG801E.1)
12.	ON/OFF SWITCH ON TELESCOPIC HANDLE (ONLY FOR WG801E.1)
13.	LOCKING KNOB (ONLY FOR WG801E.1)
14.	INNER HANDLE (ONLY FOR WG801E.1)
15.	CONNECTION BRACKET (ONLY FOR WG801E.1)

* Not all the accessories illustrated or described are included in standard delivery.

TECHNICAL DATA

	WG801E	WG801E.1	WG801E.9
Voltage	20 V Max*		
No Load Speed	1150 rpm		
Cutting width	10cm with grass shear blade		
Cutting length	12/20cm with shrub blade	12cm	12/20cm with shrub blade
Max. cutting diameter	8mm for shrub blade		
Charging time	5 hrs	/	
Charger rating	Input: 100-240V~50/60Hz Output: 20V 400mA	/	
Machine weight: (with grass shear blade)	0.9 kg	0.5 kg	

*Voltage measured without workload. Initial battery voltage reaches maximum of 20 volts. Nominal voltage is 18 volts.

NOISE INFORMATION

A weighted sound pressure	L_{pA} : 66dB(A)
A weighted sound power	L_{wA} : 82dB(A)
K_{pA}	3.0dB(A)
Wear ear protection	

VIBRATION INFORMATION

Typical weighted vibration	$a_h < 3.6m/s^2$
	uncertainty $K=1.5m/s^2$

WARNING: The vibration emission value during actual use of the power tool can differ from the declared value depending on the ways in which the tool is used dependant on the following examples and other variations on how the tool is used:
How the tool is used and the materials being cut or drilled.
The tool being in good condition and well maintained.
Using the correct accessory for the tool and ensuring it is sharp and in good condition.
The tightness of the grip on the handles and if any anti vibration accessories are used.
And the tool is being used as intended by its design and these instructions.

This tool may cause hand-arm vibration syndrome if its use is not adequately managed.

WARNING: To be accurate, an estimation of exposure level in the actual conditions of use should also take account of all parts of the operating cycle such as the times when the tool is switched off and when it is running idle but not actually doing the job. This may significantly reduce the exposure level over the total working period.

Helping to minimise your vibration exposure risk. Maintain this tool in accordance with these instructions and keep well lubricated (where appropriate).
If the tool is to be used regularly then invest in anti vibration accessories.
Plan your work schedule to spread any high vibration tool use across a number of days.

Cordless shrub shear / grass shear
WG801E WG801E.1 WG801E.9

ACCESSORIES

	WG801E	WG801E.1	WG801E.9
10cm Grass shear blade	1	1	1
12cm Shrub shear blade	1	1	1
20cm Shrub shear blade	1	/	1
Battery pack	1	1	/
Charger	1	1	/
Telescopic Handle (WA0040)	/	1	/

We recommend that you purchase your accessories from the same store that sold you the tool. Refer to the accessory packaging for further details. Store personnel can assist you and offer advice.

OPERATING INSTRUCTIONS



NOTE: Before using the tool, read the instruction book carefully.

INTENDED USE

The product is intended for light trimming of shrubs and lawn edges in domestic use.

ASSEMBLY & OPERATION

ACTION	FIGURE
ASSEMBLY (Fitting/Changing the blade)	
Removing the blade Warning: Wear gloves when changing the blade.	See Fig. A1, A2
Fitting the blade	See Fig. B1, B2
BEFORE OPERATION	
Checking the battery condition (Only for WG801E/WG801E.1)	See Fig. C1
Charging the battery pack More details can be found in charger's manual	See Fig. C2
Installing the battery pack	See Fig. C3
Removing the battery pack	See Fig. C4
OPERATION	
Starting & Stopping	See Fig. D

Trimming grass NOTE: Keep the tool away from hard objects and delicate plants. To make a closer cut, slightly tilt the tool.	See Fig. E
Trimming hedges and shrubs NOTE: Take care to avoid any foreign objects. Especially avoid hard objects such as metal wire and railings, as these could damage the blades.	See Fig. F
Operating with the telescopic handle (Only for WG801E.1)	
Assembling/removing the telescopic handle NOTE: -Install the battery pack first before assembling the telescopic handle. -Make sure the telescopic handle is locked into position securely before operation. -Keep hands away from the on/off switch when attach or remove the telescopic handle to prevent accidental start.	See Fig. G1, G2
Adjusting the handle length NOTE: The locking knob is used to hold the handle in position at any extended length.	See Fig. H
Adjusting the cutting height NOTE: The telescopic handle has two cutting height levels (25mm & 43mm).	See Fig. I1, I2
Starting and stopping with the telescopic handle Warning: Do not use the shrub shear blades (12cm/20cm) when working with the telescopic handle.	See Fig. J

MAINTENANCE

NOTE: To ensure long and reliable service, carry out the following maintenance regularly.
Remove the battery before carrying out any adjustment, servicing or maintenance.
Check for obvious defects such as loose, dislodged or damaged blade, loose fixings and worn or damaged components.
Check that covers and guards are undamaged and correctly fitted. Carry out necessary maintenance or repairs before using.

BLADE MAINTENANCE

Always clean the cutting blades after operation and periodically lubricating the cutting blade.
Visually check the condition of the cutting edges of the cutting blade.
Ensure that the blade is covered with the blade guard supplied when not in use.

Cordless shrub shear / grass shear

WG801E WG801E.1 WG801E.9

CLEANING/STORAGE

Clean the exterior of the machine thoroughly using a soft brush and cloth. Do not use water, solvents or polishes. Remove all debris, especially from the ventilation slots.

Store the machine in a secure dry place out of reach of children. Do not place other objects on top of the machine.

ENVIRONMENTAL PROTECTION

 Waste electrical products must not be disposed of with household waste. Please recycle where facilities exist. Check with your local authorities or retailer for recycling advice.

DECLARATION OF CONFORMITY

We,
Positec PowerTools (Europe) Ltd, PO Box 6242,
Newbury, RG14 9LT, UK

Declare that the product,
Description **WORX cordless shrub shear and grass shear**
Type **WG801E WG801E.1 WG801E.9**
(800-809-designation of machinery, representative of grass shear/shrub)
Function **Cutting grass, trimming hedges and bushes**

Complies with the following Directives,
2006/42/EC
2014/30/EU
2011/65/EU&(EU)2015/863
2000/14/EC amended by 2005/88/EC

2000/14/EC amended by 2005/88/EC:
- Conformity Assessment Procedure as per **Annex V**
- Measured Sound Power Level **79.4dB (A)**
- Declared Guaranteed Sound Power Level **82dB (A)**

Standards conform to,
EN 60335-1
EN 50636-2-94
EN 62233
EN ISO 3744
EN 55014-1
EN 55014-2
EN 60745-1
EN 60745-2-15

The person authorized to compile the technical file,
Name Jim Kirkwood
Address Positec Power Tools (Europe)Ltd,
PO Box 6242, Newbury, RG14 9LT, UK



2017/11/27
Allen Ding
Deputy Chief Engineer, Testing & Certification
Positec Technology (China) Co., Ltd.
18, Dongwang Road, Suzhou Industrial
Park, Jiangsu 215123, P. R. China



After-sales Service and Application

At www.worx.com you can order spare parts or arrange the collection of a product in need of servicing or repair.

Tel. Service: 0345 202 9679

E-Mail: customerservices@worxtools.com

www.worx.com

Copyright © 2020, Positec. All Rights Reserved.
AR01329302